

ADELAIDE ARCADE

Adelaide Arcade is Adelaide's most beautiful shopping arcade, offering a unique experience for the discerning. It has over 70 specialty retail and service outlets including six of the finest jewellers in the state and the only Rolex and Cartier boutique. Between them they carry some of the worlds most sort after and precious gems from Argyle Pink Diamonds to the worlds best pearls. The unique mix includes Adelaide's best dry cleaner, clothing repairs and shoe repairs. Many other high quality services also call Adelaide Arcade home. The balcony level is occupied by a combination of office and retail tenants including podiatrist, specialist women's shoes, architect, solicitor, Adelaide's only bespoke tailor, courtiers and artists creating beautiful jewellery and art objects. Café's and chocolate shops headed by Haighs and Koko Black add to the variety while different and exclusive gifts, watches, pens and Australian souvenirs are all part of Adelaide Arcade's unique offer.

SHOP 144 Details

- High profile shop located on the first floor of Adelaide Arcade.
- Traffic volumes provide excellent exposure to passing shoppers.
- Turn key commercial property solution
- Excellent window frontage for maximum retail exposure.
- Tenancy suitable for office or retail use
- Proactive management with full time onsite facilities manager.
- Shop size approx. 42.8 sqm
- Permitted use: open to negotiation.
- Rental open to negotiation depending on terms and length of lease.

AGENT DETAILS
Evans & Ayers Pty Ltd
RLA 213689

GPO Box 460 Adelaide SA 5001
Phone: 8223 5522
Email: Accounts@adelaidearcade.com.au

LEGEND	
CLW	CENTRELINE OF WALL
IFG	INSIDE FACE OF GLASS
IFW	INSIDE FACE OF WALL
MFG	MALL FACE OF GLASS
MFW	MALL FACE OF WALL



PCA LEASE PLAN
SHOP 144
 IN THE AREA NAMED
ADELAIDE ARCADE
ADELAIDE

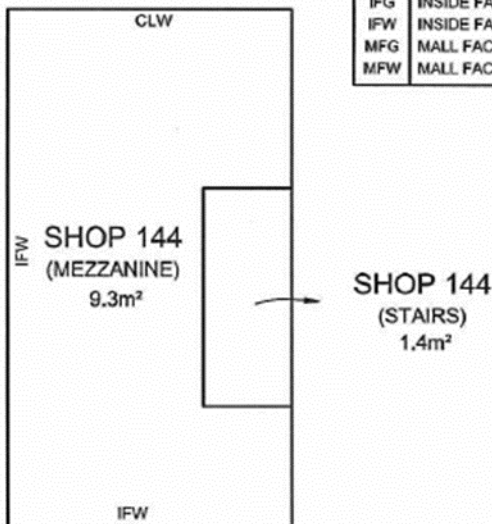

PCA Schedule of Areas

SHOP 144 at First Floor level	32.1m ²
SHOP 144 Mezzanine	9.3m ²
SHOP 144 Stairs	1.4m ²
Total G.L.A.R SHOP 144	42.8m²

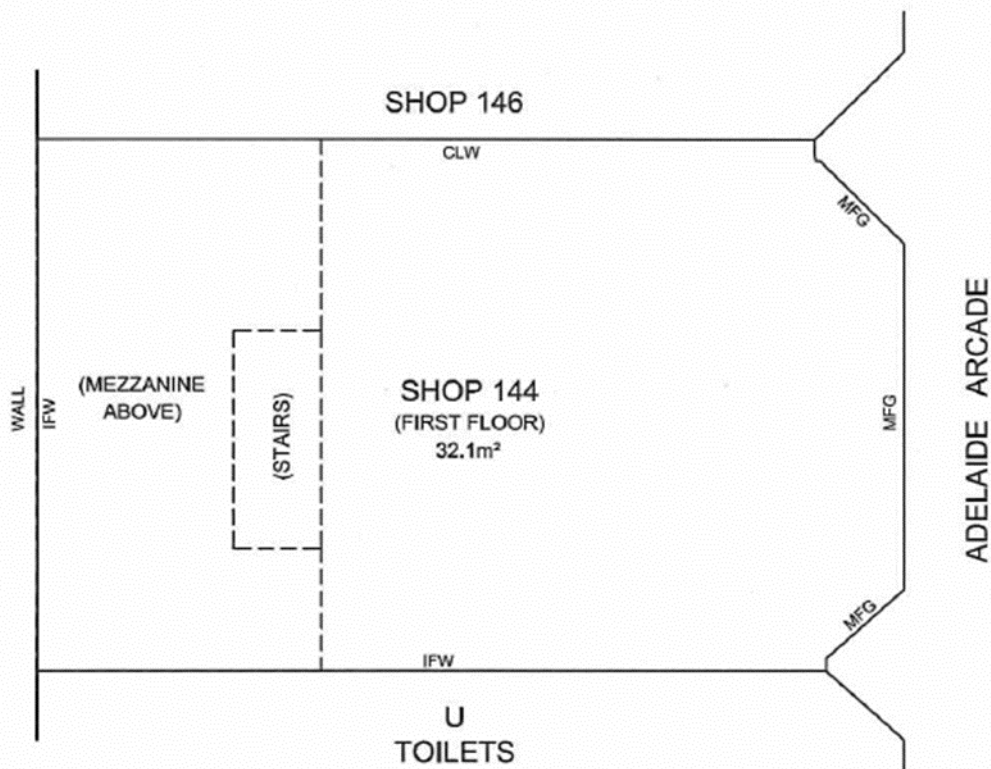

Alexander & Symonds Pty Ltd
 11 King William Street Kent Town,
 South Australia 5067
 PO Box 1000 Kent Town, SA 5071
 DX 209 ABN 93007 753 980

T (08) 8130 1666
 F (08) 8362 0099
 W www.alexander.com.au
 E adelaide@alexander.com.au

+ Property + Land Development +
 + Construction + Mining +
 + Spatial Information Management +



Property Council of Australia (PCA) Note:
 1. LANDS AND TOWNPLANNING DEPARTMENT HAS BEEN ADVISED
 BY ACCORDANCE WITH AND UNDER THE PROVISIONS OF
 THE PROPERTY COUNCIL OF AUSTRALIA METHOD OF
 MEASUREMENT, REVISED EDITION MARCH 1997 PART 2
 (GROSS LETTABLE AREA METAL (GLA/M))
 2. ALL PARTIES USING THE AREAS EXPRESSED UPON THIS
 SKETCH SHOULD AGREE WITH THE BOUNDARY
 DECLARATIONS

0 0.5 1 1.5 2 2.5

SCALE 1:50 METRES
 AT ORIGINAL SHEET SIZE A4

Craig Barwick
 LICENSED SURVEYOR

REFERENCE **A099208.00**

DWG No A099208PCA 144

FIELD BOOK DNK

KJD 5.2.2009